



Glos IA

System for fresh air

I. Description

System of solutions for fresh air as compensation of evacuated hot gases in event of fire. It is an element of smoke and heat ventilation system. It can be used as part of a system for natural ventilation or combination of both systems.

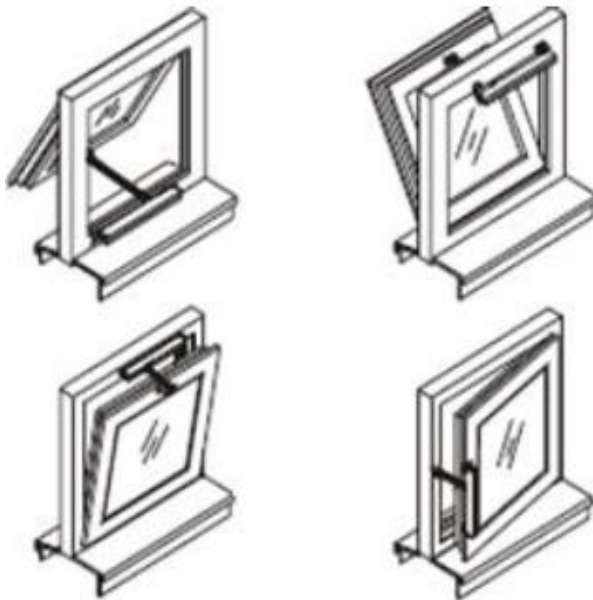

GLOS IA should be synchronized with a smoke evacuation system. Controlling system of inlet flaps could consist of different elements depending on the type of opening device. It is absolutely necessary that the controlling central of inlet flaps be equipped with an independent power supply and be coupled with other elements of a smoke and heat evacuation system. In case of use of GLOS IA as a part of global system for natural ventilation, the system must be controlled by a meteorological central.

1.1.Integrity in

- All types of facades and constructions
- Glass construction

1.2. Function

- Natural daylight
- Natural ventilation
- Smoke and heat ventilation



II. Type systems profiles

Gloss IA can be produced by different system profiles.

2.1. Sament M9650

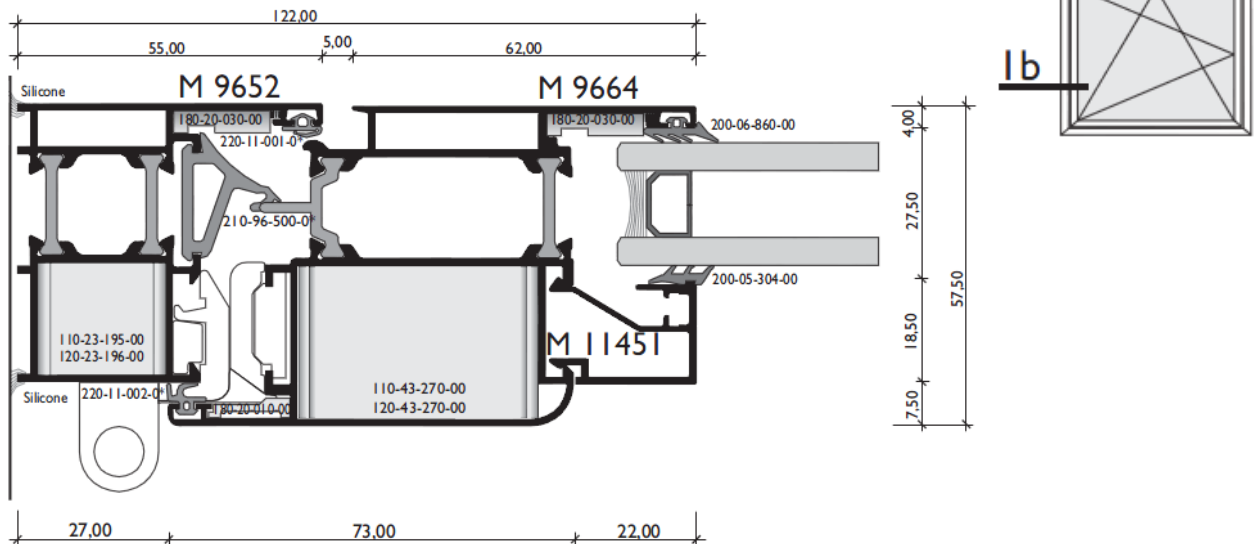

2.2. Sament E40

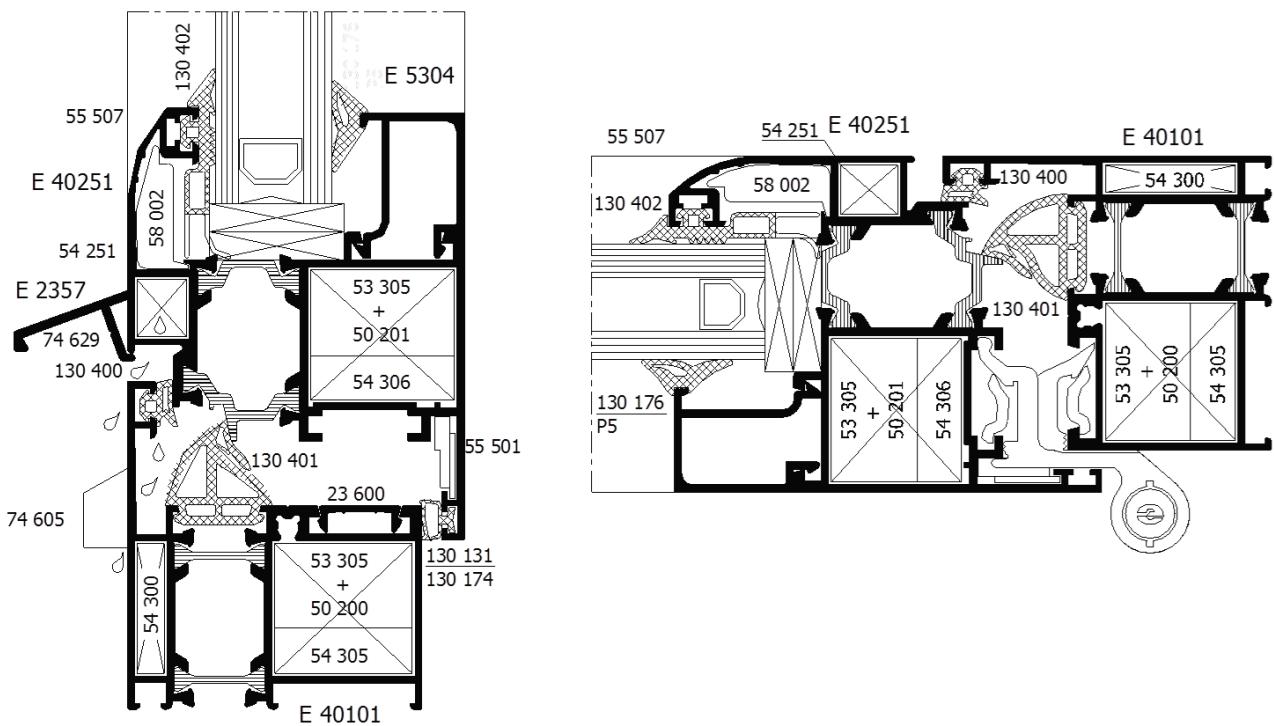



2.3. Sament E45

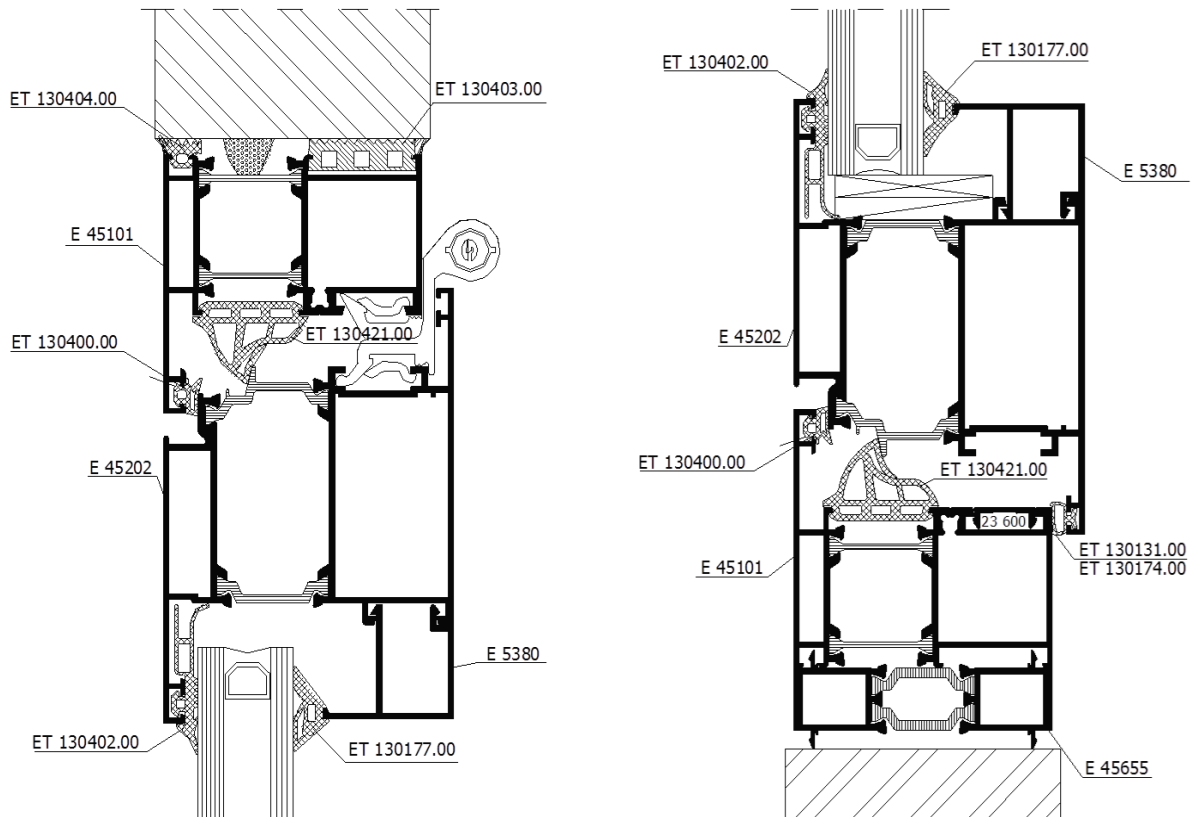

2.4. Sament IA

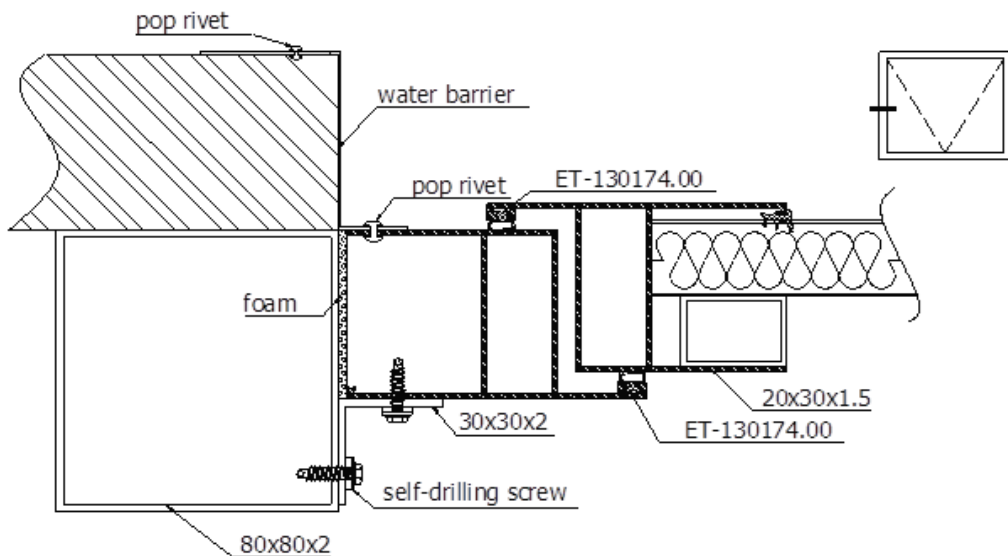

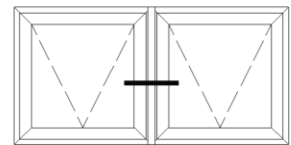
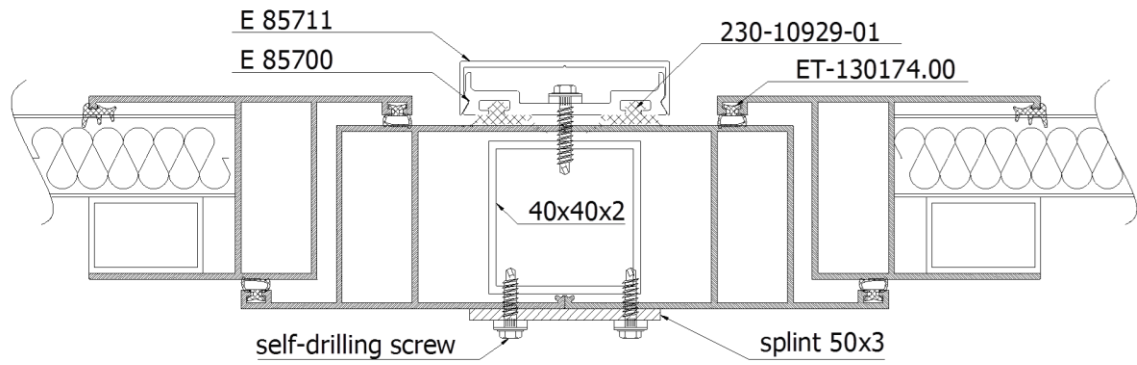

II. Components

2.1.Sizes:

- From 500 to 2000mm width
- From 500 to 2500mm length

Casement and sashes		
1	Sament M9650	
2	Sament E40	
3	Sament E45	
4	Sament IA	



Additional elements, joint corner brackets and gaskets		
1	Sament M9650	
2	Sament E40	
3	Sament E45	
4	Sament IA	



2.2.Filling types

2.2.1. Cellular polycarbonate

Application 1

No	Solution	View
1	PC 10mm	
2	PC 16mm	
3	PC 20mm	
4	PC 25mm	
5	PC 32mm	
6	PC 40mm	

2.2.2. Package solutions







Application 2

No	Solution	View
1	PC 10 + 10 mm	
2	PC 16 + 16 mm	
3	PC 10 + 20 mm	

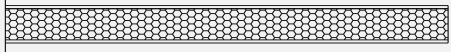
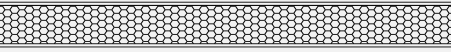
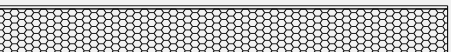
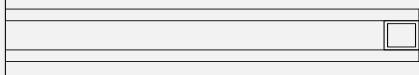

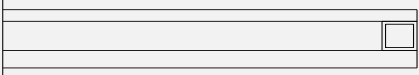
2.2.3. Other solutions

Application 3

№	Solution	View
1	thermo panel 20mm	
2	thermo panel 22mm	
3	thermo panel 24mm	
4	Glass package 4+4mm/18mm	
5	Glass package 4+5mm/19mm	
6	Glass package 4+6mm/20mm	
7	Glass package 5+5mm/20mm	
8	Glass package 5+6mm/21mm	
9	Glass package 6+6mm/22mm	

Note: 1. Available package solution with reinforced inner layer for high placement

2. Spacers in glass packages may have different sizes 20x10mm, 20x20mm, 30x20mm



III. Ventilation function

- Chain drive

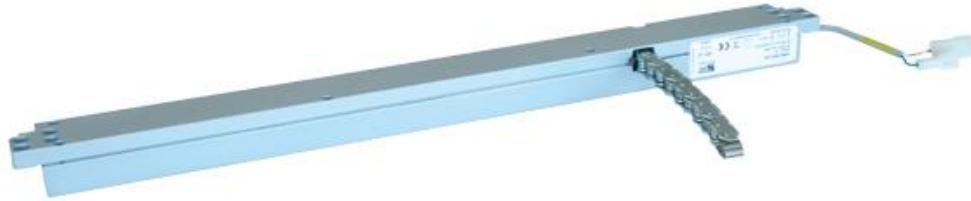

- Pneumatic cylinder. Opening height - 300/500mm



Note: For more information, please contact your consultant.